

# Adult Left IO Leg

## Replacing the Tibial IO Pad

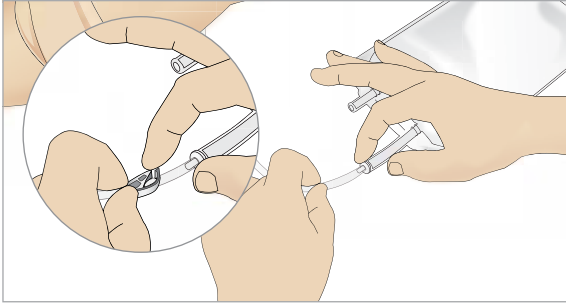

1 Attach the Tibial IO bag to the Tibial tube and close off the pinch clamp.

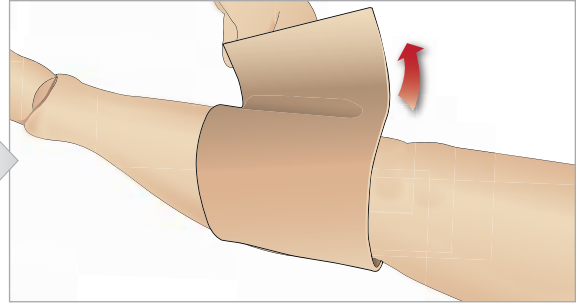

2 Detach the Velcro™ securing the IO leg skin to expose the Tibial IO module.

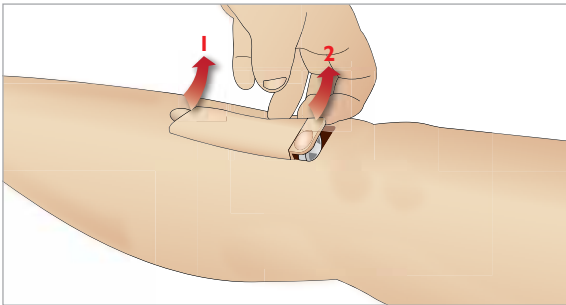

3 Remove the Tibial IO unit from the leg.

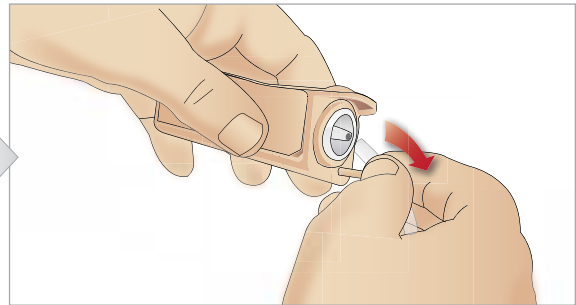

4 Remove the tube from the Tibial IO module.

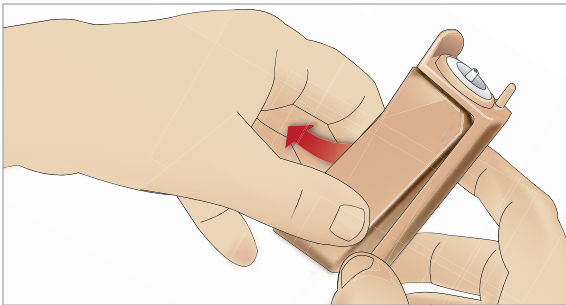

5 Remove the Tibial IO Pad from the Tibial IO chassis.

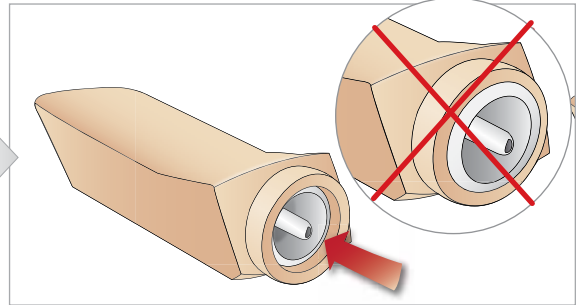

6 Before replacing the new Tibial IO pad, ensure that the nipple is retracted in the Tibial IO Pad. This will ease the installation of the pad into the chassis.

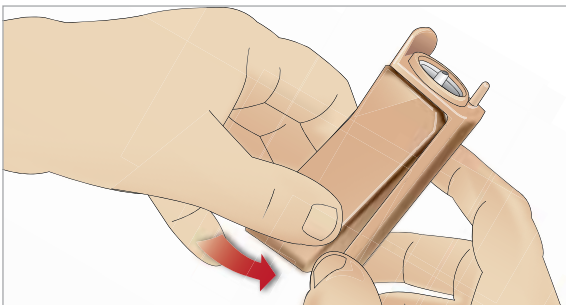

7 Fit the new Tibial IO pad into the chassis.

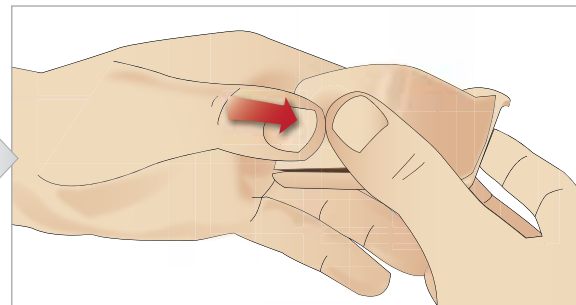

8 Secure the Tibial IO pad in place by pressing the rear of the pad with thumbs until the nipple moves forward and locks the unit in place. Refer to steps 1-4 on page 2 for installation and filling of the IO module.

# Preparing for Simulation

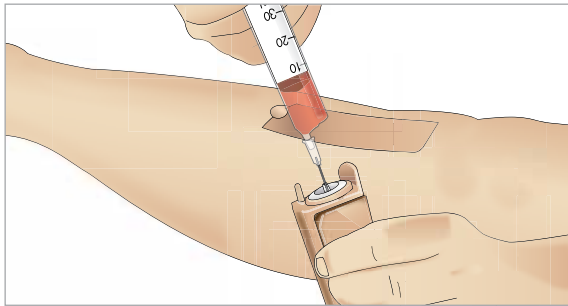

1 Refer to page 1, steps 1-4 for IO module removal. Fill the Tibial IO module with 30 - 35ml of blood mixture, ensure the Tibial Pad is completely full (syringe not included).

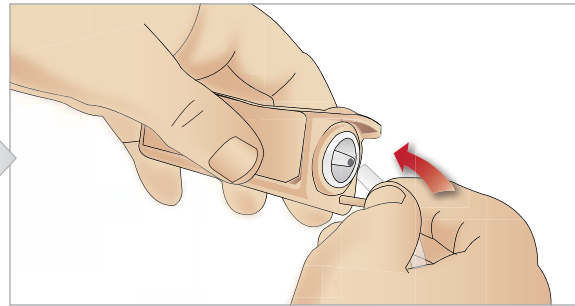

2. Connect the Tibial tube to the Tibial IO unit.

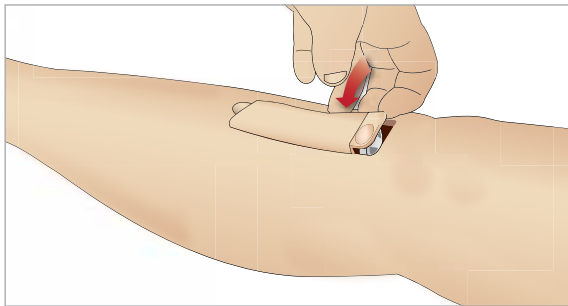

3. Replace the Tibial IO Pad and chassis, into the leg cavity.

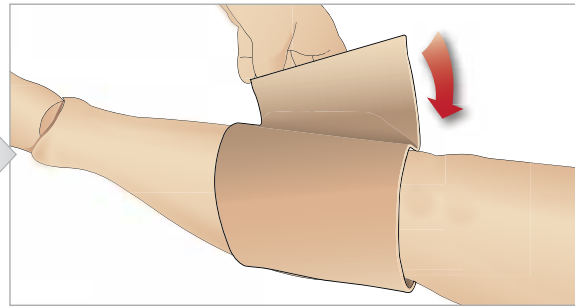

4. Replace the IO leg skin and unpinch clamp on Tibial tube. The Tibial IO is now ready for simulation.

The following devices have been tested and are approved for use with the simulator:

- BIG Automatic Intraosseous Device
- EZ-IO-G3, 15G x 1", 1.8mm x 25mm
- Jamshidi ® Illinois Bone Marrow Aspiration/Intraosseous Infusion Needle, 18 Ga. 9/16" (14mm)-1 1/2" (38mm).



*NOTE: In some cases, there will be no blood back flow when using the BIG Automatic Intraosseous Device*

## Items Included:

- Left Lower IO Leg
- IO Leg Skin
- Tibial IO Pad
- Tibial IO Bag Set
- Red Simulated Blood

*\*Syringes and needles not included*

## Replacement Parts:

- Adult Left IO Leg 205-10150 \*
- IO Leg Skin (3) 205-10250 \*
- Tibial IO Pad 10 Pack 212-15250
- Tibial IO Chassis 212-15350
- Red Simulated Blood 300-00750
- Tibial IO Bag Set (5) 212-11750

*\* Part numbers listed represent light skin tones only unless otherwise specified. See your local representative for details and part numbers for other skin tones.*



**20-07203**

Printed in USA. All rights reserved.  
PN 20-07203 Rev B



**Laerdal**<sup>®</sup>  
helping save lives